

## HIGH POWER HP MILLING CHUCK YÜKSEK SIKMA GÜÇLÜ HP FREZE TUTUCUSU

### DIN 69871 (ISO7388-1) AD Balanced G6.3

CODE / KOD DIN 40	TAPER / KONİK	d	D	L	EURO
DIN40HP20	DIN40	20	50	85	132.00
DIN40HP25	DIN40	25	59	100	138.00
DIN40HP32	DIN40	32	70	105	145.00

CODE / KOD DIN 50	TAPER / KONİK	d	D	L	EURO
DIN50HP25	DIN50	25	59	100	180.00
DIN50HP32	DIN50	32	70	110	190.00

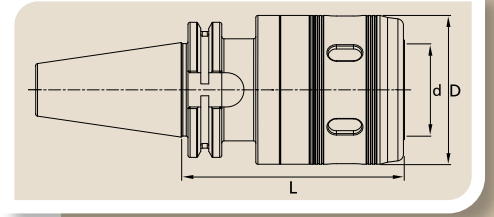

## STRAIGHT (CYLINDRICAL) REDUCTION COLLETS FOR HP MILLING CHUCKS DÜZ (SİLİNDİRİK) REDÜKSİYON PENSLELER, HP FREZE TUTUCULARI İÇİN

CODE / KOD	D outside dia dış çap	d inside dia iç çap	L	EURO
SC2003	20	3	50	11.00
SC2004	20	4	50	11.00
SC2005	20	5	50	11.00
SC2006	20	6	50	11.00
SC2008	20	8	50	11.00
SC2010	20	10	50	11.00
SC2012	20	12	50	11.00
SC2014	20	14	50	11.00
SC2016	20	16	50	11.00
SC2503	25	3	60	11.00
SC2504	25	4	60	11.00
SC2505	25	5	60	11.00
SC2506	25	6	60	11.00
SC2508	25	8	60	11.00
SC2510	25	10	60	11.00
SC2512	25	12	60	11.00
SC2514	25	14	60	11.00
SC2516	25	16	60	11.00
SC2518	25	18	60	11.00
SC2520	25	20	60	11.00
SC3204	32	4	65	12.00
SC3205	32	5	65	12.00
SC3206	32	6	65	12.00
SC3208	32	8	65	12.00
SC3210	32	10	65	12.00
SC3212	32	12	65	12.00
SC3214	32	14	65	12.00
SC3216	32	16	65	12.00
SC3218	32	18	65	12.00
SC3220	32	20	65	12.00
SC3225	32	25	65	12.00

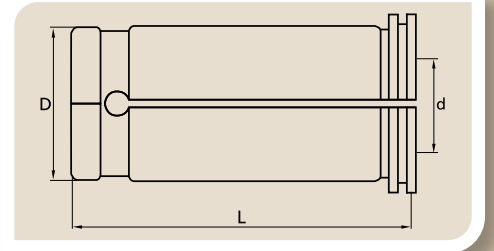

Not suitable for Hydraulic chucks  
Hidrolik tutucu için uygun değildir