

## HYDRAULIC CHUCKS HİDROLİK TUTUCULAR

### HSK63A DIN69893 / ISO 12164 Balanced G2.5

| CODE / KOD<br>HSK63A | D  | D1 | D2 | L   | EURO   |
|----------------------|----|----|----|-----|--------|
| HSK63A HY06 80       | 6  | 26 | 50 | 80  | 160.00 |
| HSK63A HY08 80       | 8  | 28 | 50 | 80  | 160.00 |
| HSK63A HY10 85       | 10 | 30 | 50 | 85  | 160.00 |
| HSK63A HY12 90       | 12 | 32 | 50 | 90  | 150.00 |
| HSK63A HY16 95       | 16 | 38 | 50 | 95  | 160.00 |
| HSK63A HY20 100      | 20 | 42 | 50 | 100 | 160.00 |
| HSK63A HY25 105      | 25 | 50 | 50 | 105 | 170.00 |
| HSK63A HY32 125      | 32 | 60 |    | 125 | 180.00 |

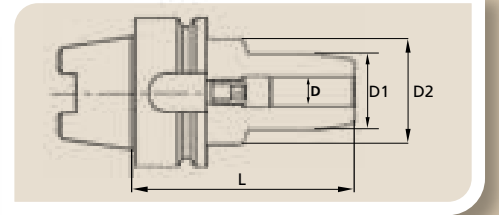

### REDUCTION COLLETS FOR HYDRAULIC CHUCKS (High Precision) Runout: Max. 5 Micron HİDROLİK TUTUCU İÇİN REDÜKSİYON PENSLELER (Yüksek Hassasiyet) Salgı: Max. 5 Micron

#### RH12 Ø12

| D  | D1<br>Clamping Range / Sıkma Aralığı | L  |
|----|--------------------------------------|----|
| 12 | 2 - 10                               | 40 |

#### RH20 Ø20

| D  | D1<br>Clamping Range / Sıkma Aralığı | L  |
|----|--------------------------------------|----|
| 20 | 2 - 18                               | 50 |

#### RH25 Ø25

| D  | D1<br>Clamping Range / Sıkma Aralığı | L  |
|----|--------------------------------------|----|
| 25 | 3 - 20                               | 54 |

#### RH32 Ø32

| D  | D1<br>Clamping Range / Sıkma Aralığı | L  |
|----|--------------------------------------|----|
| 32 | 3 - 28                               | 58 |

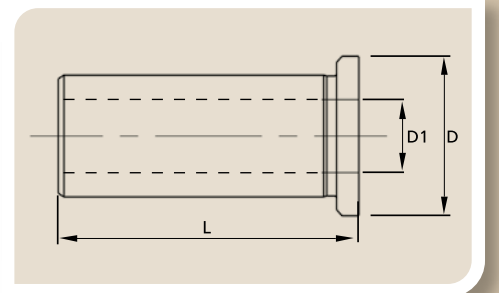

Suitable for internal and external cooling / İçten ve dıştan soğutmaya uygundur.  
Please see details at pages nr. 126-129 / Detaylar için 126-129 sayfalara bakınız.